

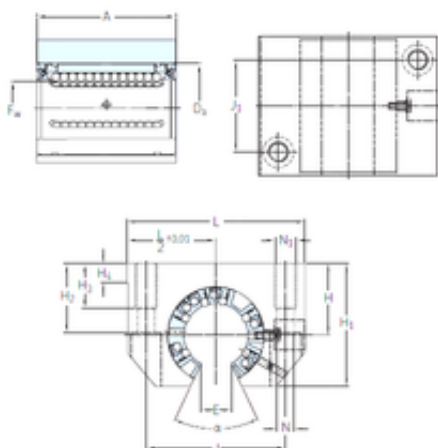

BEARING-MALAYSIA SDN.BHD.



SKF LUNF 12-2LS linear bearings

Bearing No. LUNF 12-2LS

Bore Diameter	12 mm
Fw	12 mm
H4	6 mm
H3	11 mm
Da	22 mm
Angle ()	78 °
A	32 mm
H	18 mm
H1	28 mm
H2	16,5 mm
J	32 mm
L	43 mm
N	4,3 mm
J1	23 mm
Thread (E)	7,6
Thread (N1)	M5
Weight	0,074 Kg
Basic dynamic load rating (C)	1,08 kN

LUNF 12-2LS Bearing 2D drawings and 3D CAD models