

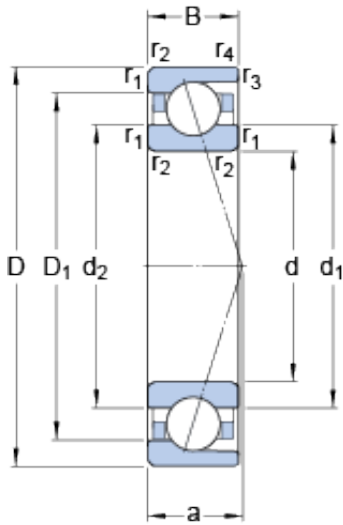

## BEARING-MALAYSIA SDN.BHD.



71956 CD/HCP4A Bearing 2D drawings and 3D CAD models

280 mm x 380 mm x 46 mm SKF 71956  
CD/HCP4A angular contact ball bearings

Bearing No. 71956 CD/HCP4A

Size	380x280x46 mm
Bore Diameter	380 mm
Outer Diameter	280 mm
Width	46 mm
d	280 mm
D	380 mm
B	46 mm
d <sub>1</sub>	311.8 mm
d <sub>2</sub>	311.8 mm
D <sub>1</sub>	348.2 mm
r <sub>1,2</sub> - min.	2.1 mm
r <sub>3,4</sub> - min.	1.1 mm
a	67.4 mm
d <sub>a</sub> - min.	291 mm
d <sub>b</sub> - min.	291 mm
D <sub>a</sub> - max.	369 mm
D <sub>b</sub> - max.	374 mm
r <sub>a</sub> - max.	2 mm
r <sub>b</sub> - max.	1 mm
d <sub>n</sub>	319.7 mm
Basic dynamic load rating - C	291 kN
Basic static load rating - C <sub>0</sub>	455 kN
Fatigue load limit - P <sub>u</sub>	10.6 kN
Limiting speed for grease	4000 r/min



## BEARING-MALAYSIA SDN.BHD.

Lubrication	
Limiting speed for oil lubrication	5600 mm/min
Ball - $D_w$	30.162 mm
Ball - $z$	31
$G_{ref}$	159 cm <sup>3</sup>
Calculation factor - $f_0$	16.7
Preload class A - $G_A$	1090 N
Preload class B - $G_B$	2180 N
Preload class C - $G_C$	4360 N
Preload class D - $G_D$	8720 N
Calculation factor - $f$	1.27
Calculation factor - $f$	1
Calculation factor - $f_{2A}$	1
Calculation factor - $f_{2B}$	1.07
Calculation factor - $f_{2C}$	1.12
Calculation factor - $f_{2D}$	1.18
Calculation factor - $f_{HC}$	1.04
Preload class A	295 N/micron
Preload class B	403 N/micron
Preload class C	565 N/micron
Preload class D	822 N/micron
$d_1$	311.8 mm
$d_2$	311.8 mm
$D_1$	348.2 mm
$r_{1,2}$ min.	2.1 mm
$r_{3,4}$ min.	1.1 mm
$d_a$ min.	291 mm
$d_b$ min.	291 mm
$D_a$ max.	369 mm



## BEARING-MALAYSIA SDN.BHD.

$D_b$ max.	374 mm
$r_a$ max.	2 mm
$r_b$ max.	1 mm
$d_n$	319.7 mm
Basic dynamic load rating C	291 kN
Basic static load rating $C_0$	455 kN
Fatigue load limit $P_u$	10.6 kN
Attainable speed for grease lubrication	4000 r/min
Attainable speed for oil-air lubrication	5600 r/min
Ball diameter $D_w$	30.162 mm
Number of balls z	31
Reference grease quantity $G_{ref}$	159 cm <sup>3</sup>
Preload class A $G_A$	1090 N
Static axial stiffness, preload class A	295 N/ $\mu$ m
Preload class B $G_B$	2180 N
Static axial stiffness, preload class B	403 N/ $\mu$ m
Preload class C $G_C$	4360 N
Static axial stiffness, preload class C	565 N/ $\mu$ m
Preload class D $G_D$	8720 N
Static axial stiffness, preload class D	822 N/ $\mu$ m
Calculation factor f	1.27
Calculation factor $f_1$	1
Calculation factor $f_{2A}$	1
Calculation factor $f_{2B}$	1.07
Calculation factor $f_{2C}$	1.12
Calculation factor $f_{2D}$	1.18
Calculation factor $f_{HC}$	1.04



## BEARING-MALAYSIA SDN.BHD.

Calculation factor $f_0$	16.7
Mass bearing	11.1 kg