

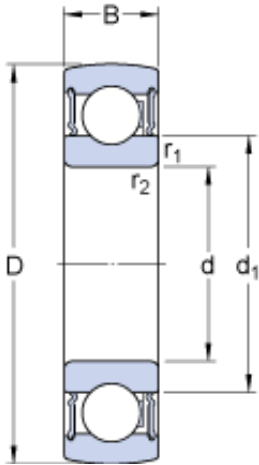

BEARING-MALAYSIA SDN.BHD.



25 mm x 62 mm x 17 mm SKF 1726305-2RS1
deep groove ball bearings

Bearing No. 1726305-2RS1

1726305-2RS1 Bearing 2D drawings and 3D CAD models

Size	62x25x17 mm
Bore Diameter	62 mm
Outer Diameter	25 mm
Width	17 mm
d	25 mm
D	62 mm
B	17 mm
d ₁	36.6 mm
r _{1,2} - min.	1.1 mm
Basic dynamic load rating - C	22.5 kN
Basic static load rating - C ₀	11.6 kN
Fatigue load limit - P _u	0.49 kN
Limiting speed	7500 r/min
Calculation factor - f ₀	12
Category	Insert Bearings Spherical OD
Inventory	0.0
Manufacturer Name	SKF
Minimum Buy Quantity	N/A
Weight / Kilogram	0.2
Product Group	M06110
Inner Race Profile	Standard Inner Ring
Outer Race Profile	Spherical
Relubricatable	No



BEARING-MALAYSIA SDN.BHD.

Seal Type	RS1 Seal
Mounting Method	Shaft Mount
Rolling Element	Ball Bearing
Snap Ring	No
Long Description	25MM Bore; Standard Inner Ring; Ball Bearing; 17MM Length Thru Bore; 17MM Outer Race Width; 62MM Outside Diameter; Not Relubricatable; RS1 Seal Seal; Shaft Mount Mounting Method; No Snap Ring
Inch - Metric	Metric
Other Features	Single Row Standard Duty Metric
Category	Insert Bearings
UNSPSC	31171536
Harmonized Tariff Code	8482.10.50.00
Noun	Bearing
Keyword String	Insert
Manufacturer URL	http://www.skf.com
Manufacturer Item Number	1726305-2RS1
Weight / LBS	0.441
Length Thru Bore	0.669 Inch 17 Millimeter
Bore	0.984 Inch 25 Millimeter
Outer Race Width	0.669 Inch 17 Millimeter
Outside Diameter	2.441 Inch 62 Millimeter
bore diameter:	25 mm
radial static load capacity:	11.6 kN
outside diameter:	2.4409 in
finish/coating:	Uncoated
outer ring width:	36.6 mm
maximum rpm:	7500 RPM
bore type:	Round
seal type:	Contact/Lip



BEARING-MALAYSIA SDN.BHD.

operating temperature range:	-40 to +210 ° F
series:	17263
radial dynamic load capacity:	11.6 kN
d_1	36.6 mm
$r_{1,2}$ min.	1.1 mm
Basic dynamic load rating C	22.5 kN
Basic static load rating C_0	11.6 kN
Fatigue load limit P_u	0.49 kN
Limiting speed ¹⁾	7500 r/min
Calculation factor f_0	12
Mass complete bearing	0.22 kg