

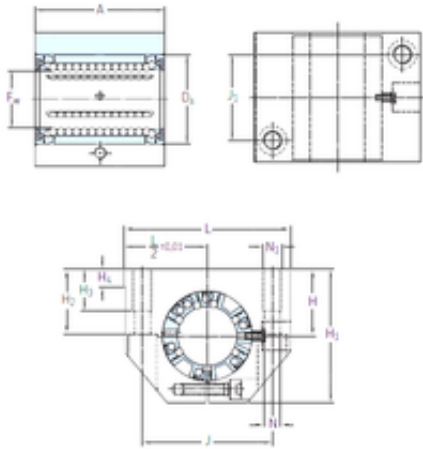

# BEARING-MALAYSIA SDN.BHD.



LUNE 30 Bearing 2D drawings and 3D CAD models

## SKF LUNE 30 linear bearings

Bearing No. LUNE 30

Bore Diameter	30 mm
Fw	30 mm
H4	9,5 mm
H3	22 mm
Da	47 mm
A	68 mm
H	35 mm
H1	70 mm
H2	34 mm
J	68 mm
L	87 mm
N	8,4 mm
J1	45 mm
Thread (N1)	M10
Weight	0,79 Kg
Basic dynamic load rating (C)	4,65 kN