

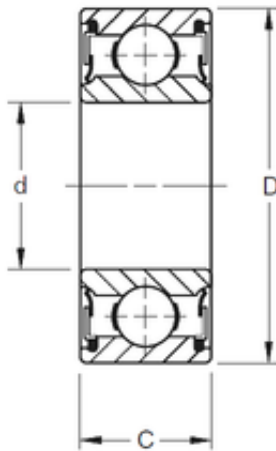

BEARING-MALAYSIA SDN.BHD.



31.75 mm x 57,15 mm x 9,52 mm Timken
S12NPP deep groove ball bearings

Bearing No. S12NPP

Size	31.75x57.15x9.52 mm
Bore Diameter	31.75 mm
Outer Diameter	57,15 mm
Width	9,52 mm
d	31.75 mm
D	57,15 mm
B	9,52 mm
C	9,52 mm
Weight	0,1 Kg
Basic dynamic load rating (C)	12,2 kN

S12NPP Bearing 2D drawings and 3D CAD models